

# BENALLA ART GALLERY

## SIMPSON GALLERY

### Exhibition Application

#### ABOUT BENALLA ART GALLERY

Housed in an iconic building and set among beautiful botanical gardens, the Benalla Art Gallery offers an unforgettable experience of art. The Gallery forms the foundation of Benalla's artistic and creative culture, with thousands of people attending workshops, artist talks, exhibition openings and other events every year.

#### ABOUT THE SIMPSON GALLERY

The Simpson Gallery is one of three exhibition spaces within the Benalla Art Gallery. The space is approximately 78 sqm, with 23 running metres of hanging space, and a large, south-facing feature window providing views to the Benalla Botanic Gardens. This space is used to present a range of exhibitions, from curated shows from the Collection, to exhibitions by emerging and established contemporary artists, and shows by artists and artist collectives from throughout north east Victoria.

The space is named after Arch Simpson, born in 1924, who studied in Melbourne during the Depression years and served as a pilot in World War II before returning to Australia and enrolling at Dookie College. Arch became involved with the Benalla Art Gallery and undertook various projects in his time, and his contributions reflect those of countless volunteers throughout Benalla Art Gallery's history.

#### HOW TO APPLY

Applicants are required to complete the attached application form, and return via email to:

**SUBJECT: Benalla Art Gallery - Simpson Gallery Exhibition Application**

[gallery@benalla.vic.gov.au](mailto:gallery@benalla.vic.gov.au)

Each Simpson Gallery Exhibition Application is reviewed by our Exhibitions Advisory Committee. The Committee will meet twice yearly to assess applications for the future program, and applicants will be notified via email as to the outcome of the review process. Applications will be assessed on:

- Innovative and engaging art forms and practice
- Works of high quality and artistic merit presented in a professional manner
- Clarity of theme/concept of the exhibition
- Relevance to the community, region, and wider Benalla Art Gallery programming
- Opportunities for education and public programs engagement
- Quality of documentation provided
- Resourcing requirements and suitability of the proposal to the physical limitations of the space

All successful applicants will be provided an Exhibition Agreement and offered a Exhibition Fee \$3,000 inc. GST.

For more information about the gallery, phone or email Benalla Art Gallery:

T 03 5760 2619 or [gallery@benalla.vic.gov.au](mailto:gallery@benalla.vic.gov.au)

Botanical Gardens  
Bridge Street  
Benalla VIC 3672

03 5760 2619  
[gallery@benalla.vic.gov.au](mailto:gallery@benalla.vic.gov.au)  
[benallaartgallery.com.au](http://benallaartgallery.com.au)



# B

# BENALLA ART GALLERY SIMPSON GALLERY

Previous Exhibition Documentation



*The Human Figure*  
Benalla Art Gallery Collection  
Wall A, Entry Doors, and Wall B



*Pauline Fraser: Contemplating Nature*  
Windows, Wall E and Wall F



*Kim Westcott: The other web*  
Ink paintings, photographs and sculptures  
Wall B, Wall D, and Windows



# **BENALLA ART GALLERY SIMPSON GALLERY**

Exhibition Application Form

## **CONTACT DETAILS**

Name:

Business Name (if applicable):

Phone:

Mobile:

Address:

Email:

ABN:

Are you registered for GST:    Yes                    No

---

## **EXHIBITION PROPOSAL**

Artist Biography (500 word max):



# **BENALLA ART GALLERY SIMPSON GALLERY**

## **Exhibition Application Form**

Exhibition Statement - please provide a brief description of the exhibition you propose to present in the Simpson Gallery (500 word max):

Relevance Statement - please explain the proposed exhibition's relevance to the Benalla community, region, and/or Gallery (200 word max):



# **BENALLA ART GALLERY SIMPSON GALLERY**

## **Exhibition Application Form**

Engagement Statement - please discuss any educational or engagement activities you would be willing to participate in to enrich the audience's experience of the exhibition (200 word max):

Resourcing Requirements - please discuss how you will secure any specific financial or material resourcing requirements which exceed the available Exhibition Fee (200 word max):

Technical Detail - please discuss any specific technical or spatial requirements to install the exhibition (200 word max):



# **BENALLA ART GALLERY SIMPSON GALLERY**

## **Exhibition Application Form**

Images - Please provide 3-5 images of your proposed works with full credit lines, as below. If you are proposing to exhibit new work that has not yet been produced, please clearly note that the images provided are indicative only.

Artist Name

Artwork title Year of Production

Medium

Size (height x width x depth in cm)

Price (inclusive of GST if applicable and 30% Gallery commission if also available for sale)

Edition number if applicable

Further Information - Please provide links to your artist CV, website and/or professional Facebook page:

---

I understand that this is an application only and that a signed Exhibition Agreement is required to confirm the exhibition.

Signed:

Date:

# BENALLA ART GALLERY SIMPSON GALLERY

## Floor Plan and Elevations

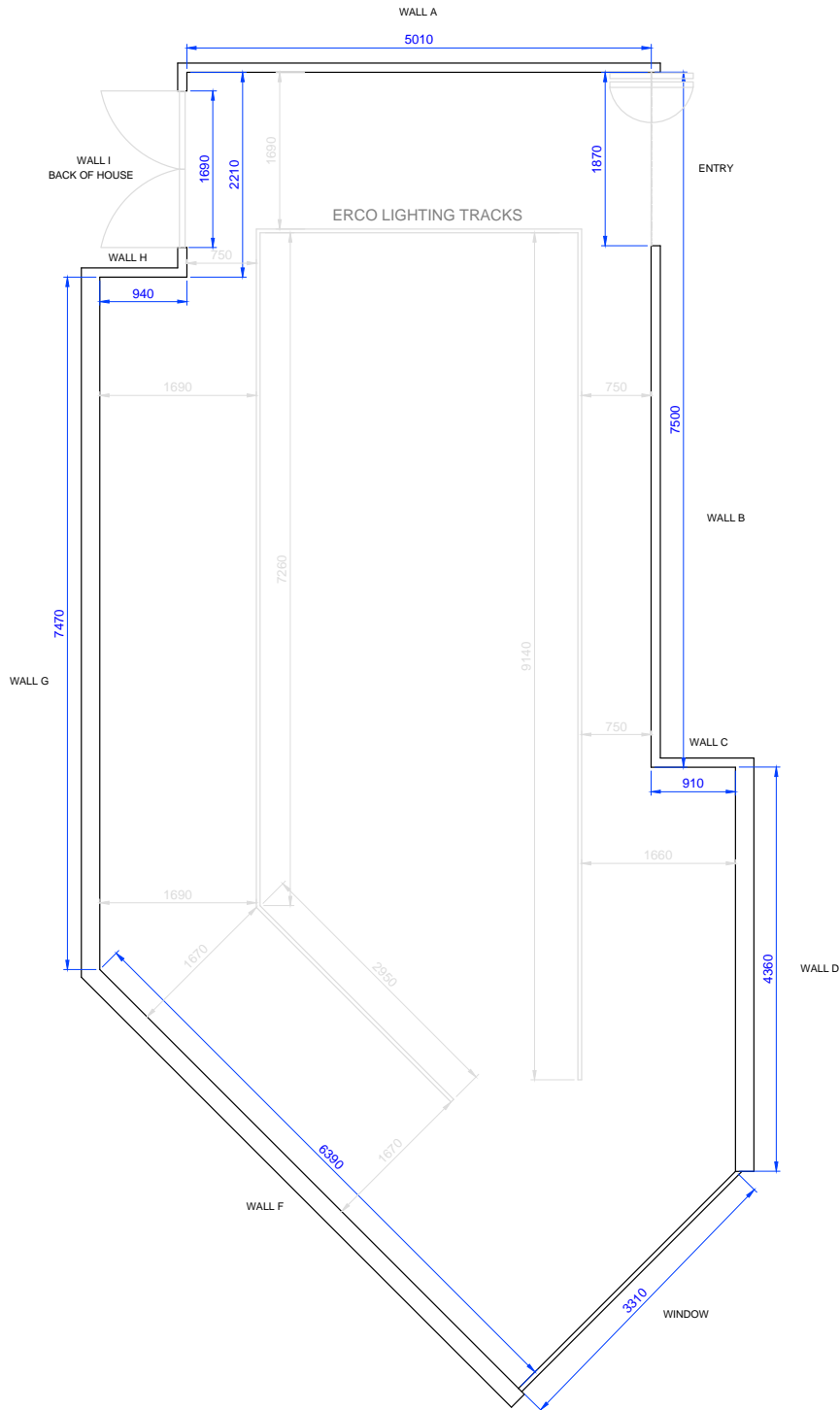

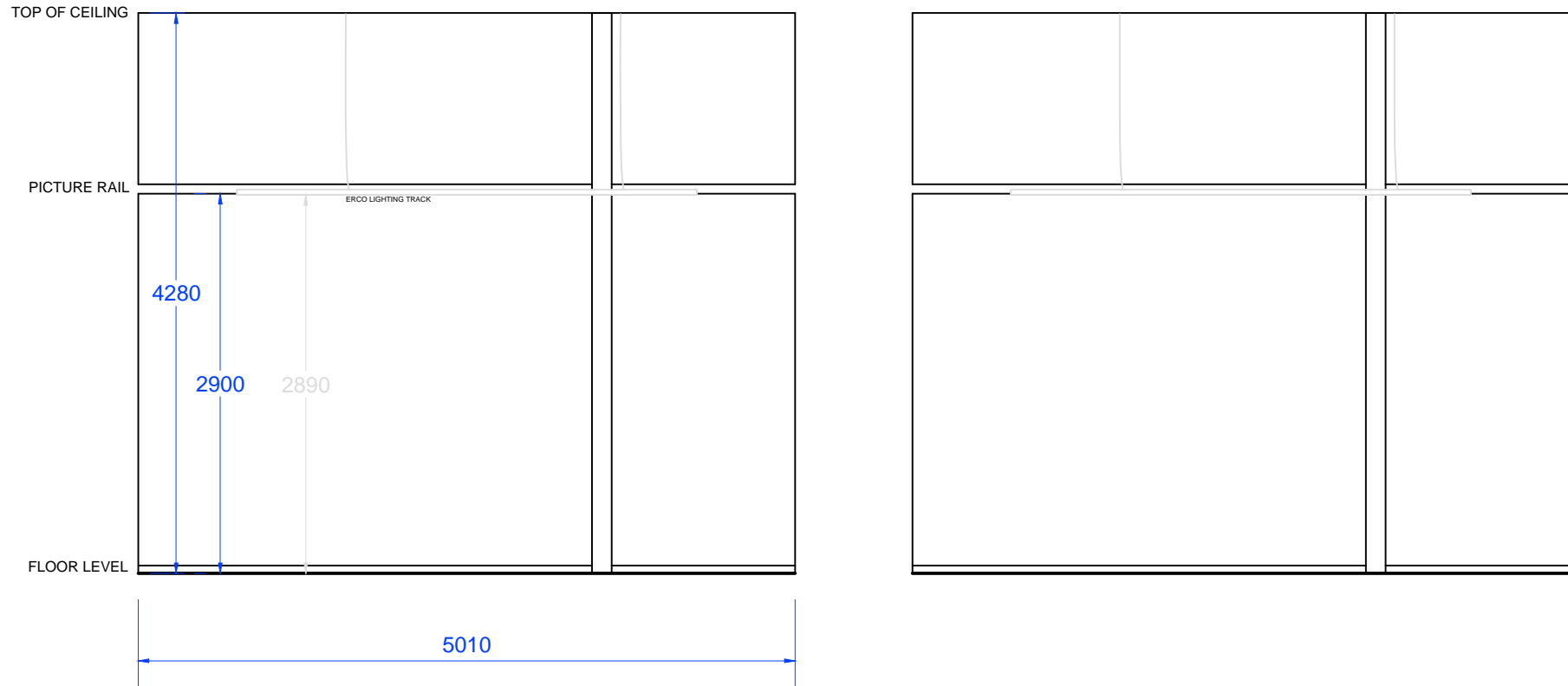

## SIMPSON GALLERY WALL A ELEVATIONS



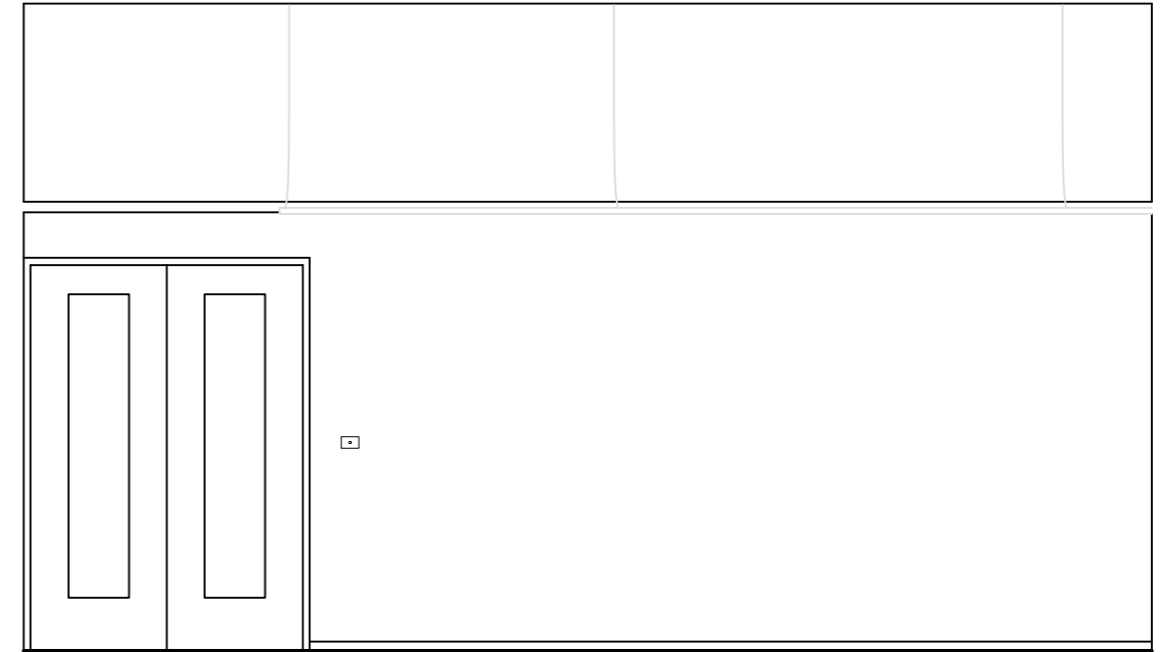
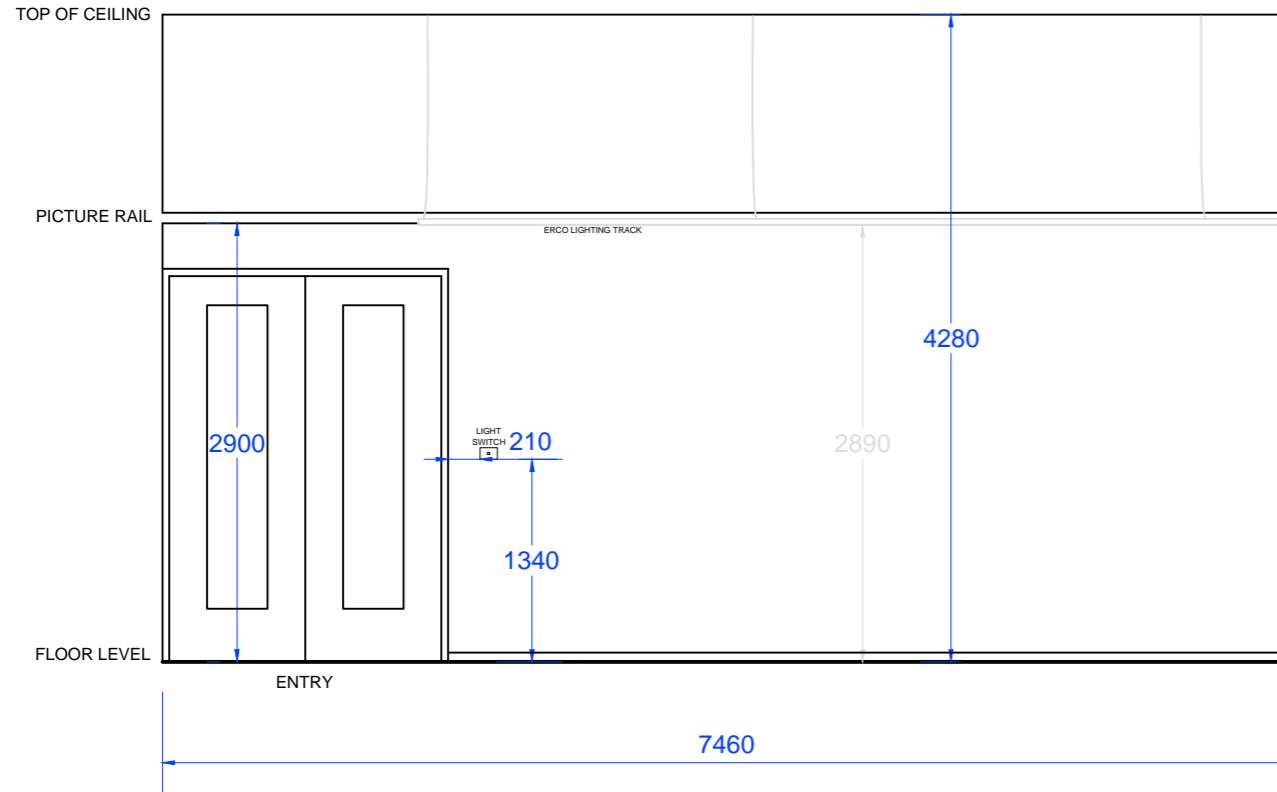

## SIMPSON GALLERY WALL B ELEVATIONS

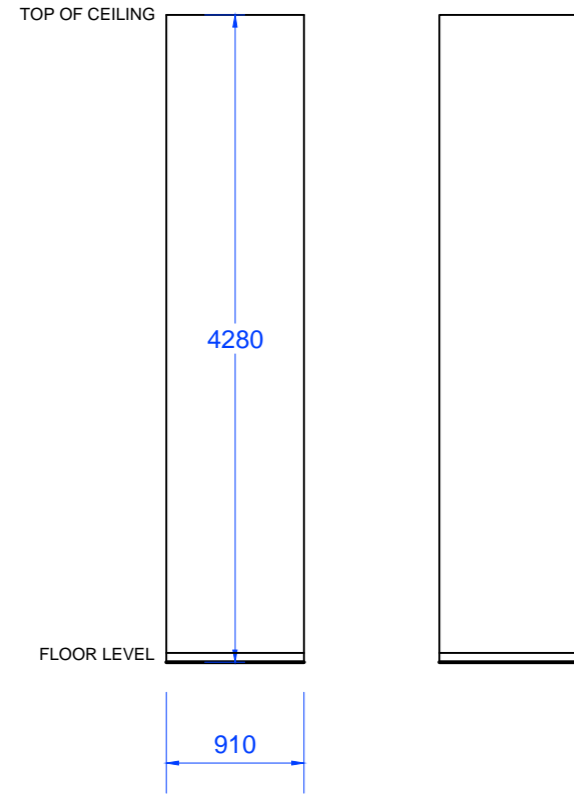

SIMPSON GALLERY  
WALL C ELEVATIONS

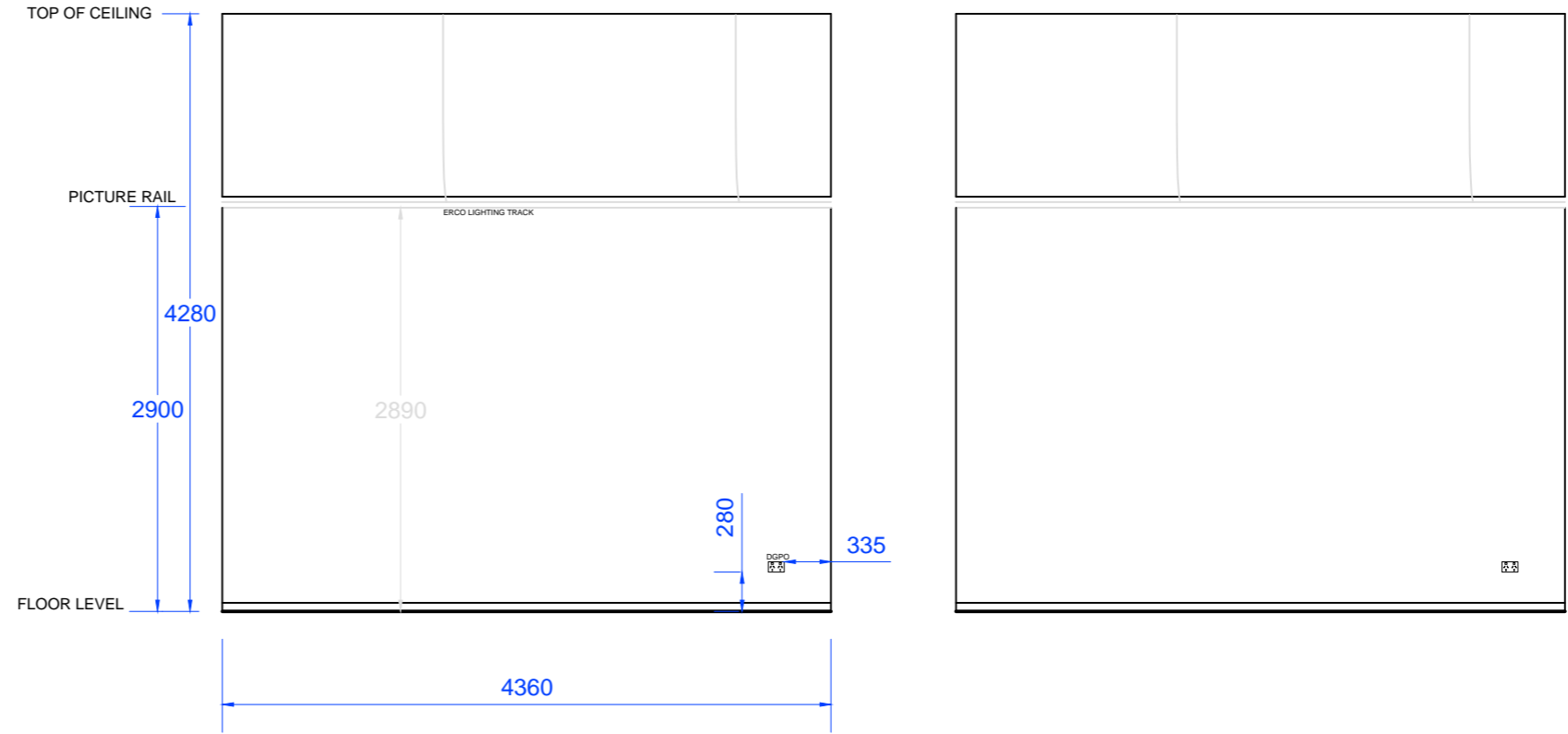

SIMPSON GALLERY  
WALL D ELEVATIONS

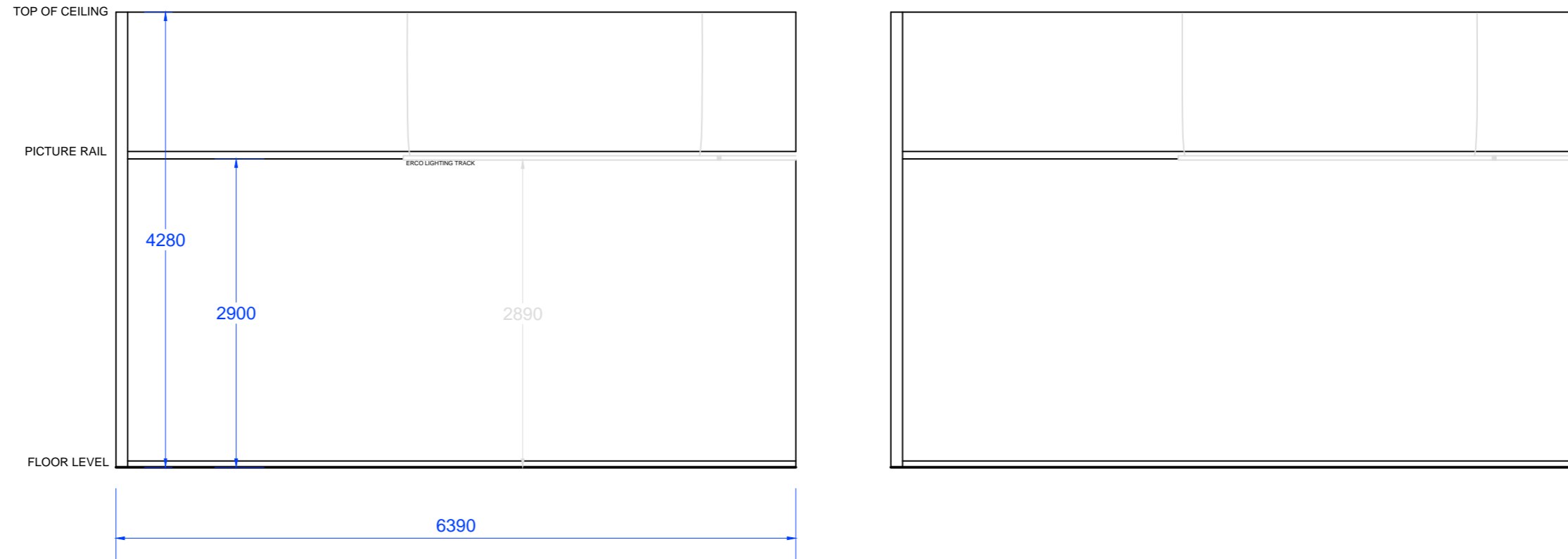

### SIMPSON GALLERY WALL F ELEVATIONS

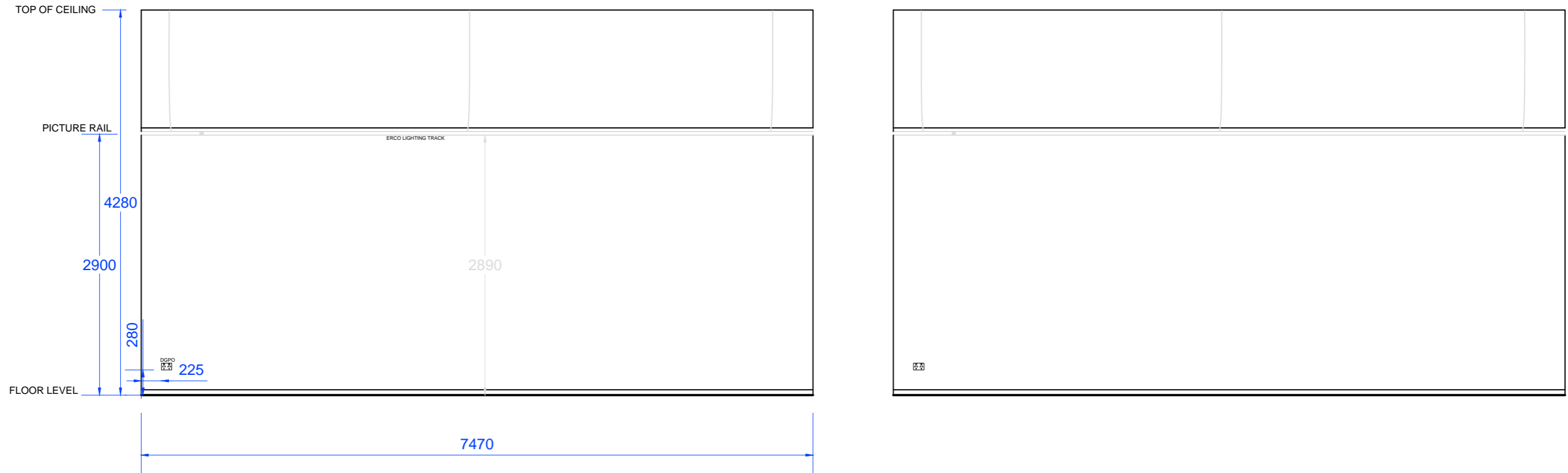

## SIMPSON GALLERY WALL G ELEVATIONS

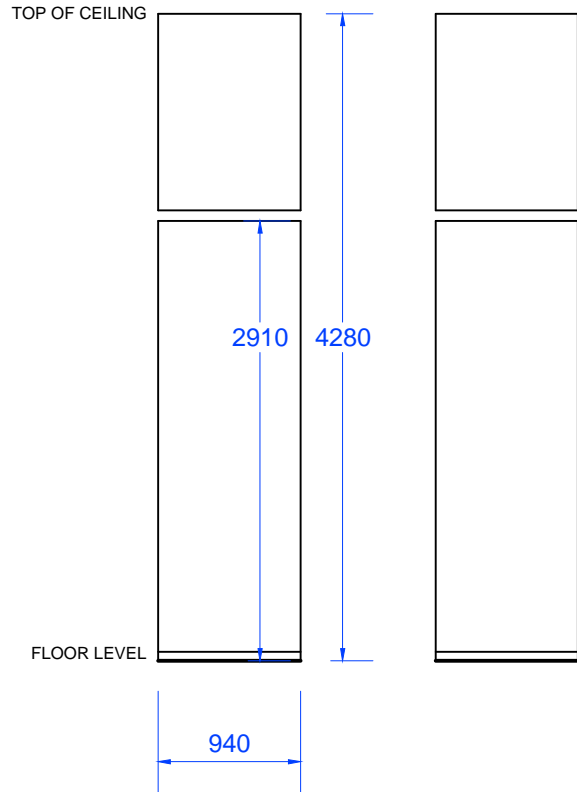

SIMPSON GALLERY  
WALL H ELEVATIONS

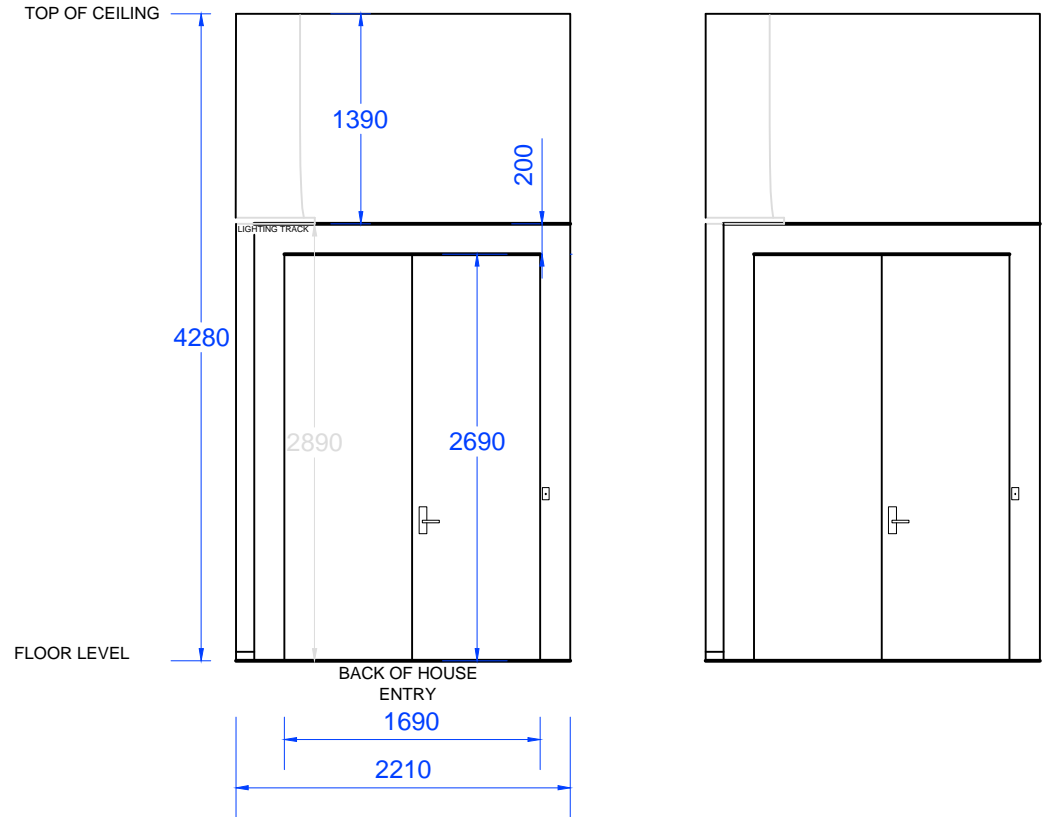

SIMPSON GALLERY  
WALL I ELEVATIONS

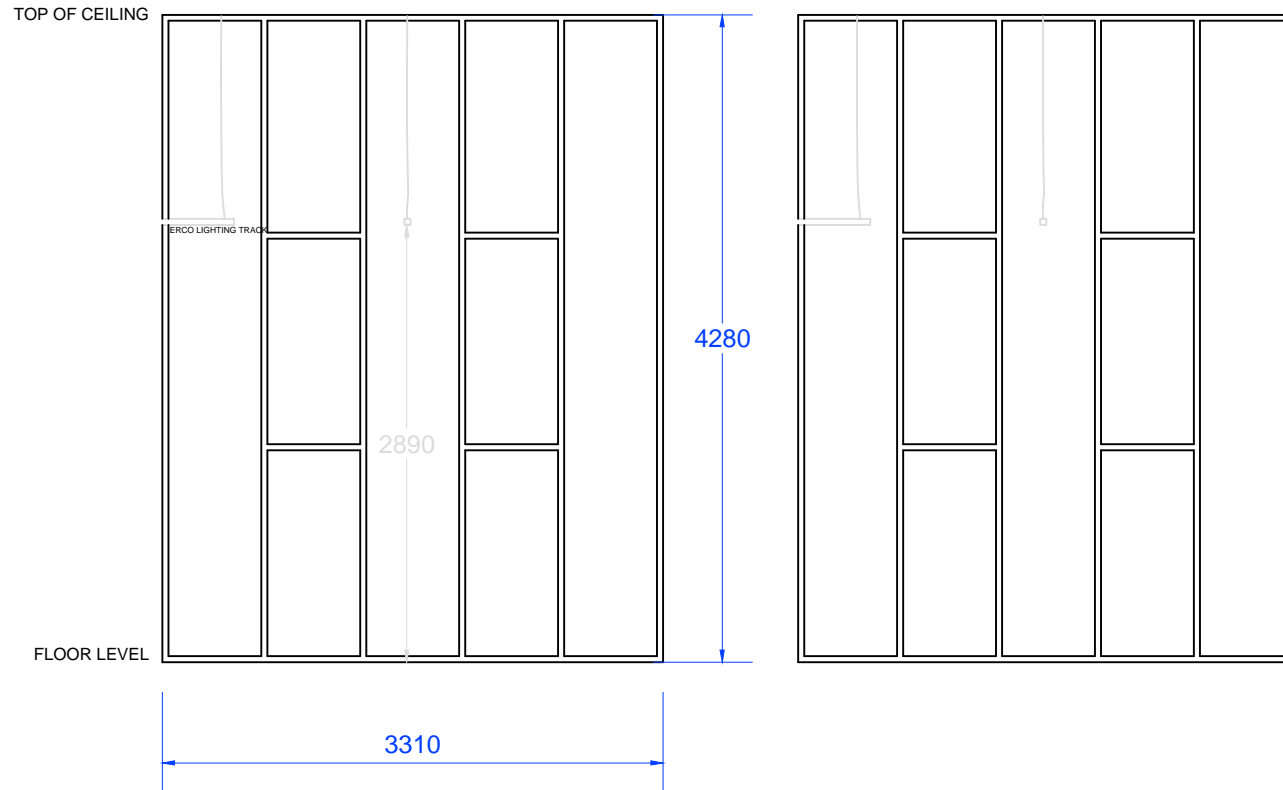

## SIMPSON GALLERY WINDOW ELEVATIONS